

Thickness: 19mm

Limit Height (mm)	Sugestion	Width (mm)														
		100	197	297	347	397	447	497	547	597	697	797	897	997	1097	1197
172	157									46,21€			66,30€			
188	173					40,73€	43,48€	46,09€	48,07€	53,12€		63,47€	70,02€	78,74€	84,42€	90,04€
	188															
282	232															
	262					46,50€	49,63€	52,61€	55,65€	60,64€		72,46€	83,40€	89,88€	96,37€	102,79€
	282															
377	350					54,53€	58,21€	61,70€	65,26€	78,11€		84,98€	97,81€	105,42€	113,03€	120,55€
	377															
397	397	20,82€		47,48€	52,30€	56,58€	62,12€	65,85€	70,19€	81,82€	90,65€					
440	440			50,33€	55,43€	60,68€	65,56€	69,50€	73,52€	85,69€	94,94€					
595	547															
	595	28,62€		62,91€	69,29€	75,44€	81,51€	86,41€	91,39€	111,66€	118,03€					
697	697	36,43€		77,45€	84,69€	91,94€	99,20€	106,40€	113,63€	120,87€	133,92€					
757	730															
	740	37,15€	75,71€	83,13€	90,90€	98,69€	109,29€	113,25€	121,68€	130,38€	143,74€					
	757															
847	847	44,20€		88,81€	98,61€	108,37€	118,15€	126,48€	135,33€	144,46€	155,03€					
890	890	46,43€		92,67€	102,61€	112,77€	124,15€	132,90€	141,68€	149,86€	162,35€					
947	947	49,33€		98,33€	108,76€	118,96€	130,82€	140,04€	149,41€	155,91€	171,80€					
990	990	51,49€		101,96€	111,48€	121,50€	135,01€	145,57€	152,61€	159,46€	177,45€					
1047	1047			106,51€	117,48€	128,01€	139,51€	150,42€	158,20€	168,28€	186,45€					
1090	1090			108,88€	119,70€	130,48€	141,28€	152,06€	162,86€	173,59€	192,33€					
1817	1817	64,36€				192,78€	204,93€	227,86€		262,85€						
2267	2267	80,27€				223,61€	237,69€	262,29€		304,90€						
2467	2467	87,35€				243,31€	258,63€	287,57€		331,77€						

Finishes and Sides												
Width (mm)	Height (mm)											
	400	550	700	740	850	880	890	950	990	1940	2390	2590
352	53,32€	68,39€	81,53€	83,15€	91,05€		95,33€	101,74€	106,03€			
602		113,63€				142,60€				280,17€	321,01€	347,89€

**Observations**
**Chipboard doors coated with Touch HPL on both faces**

Anti-fingerprint material | possibility of repairing small scratches

Prices shown in €/ un, without handle and without drilling.

- Drilling service has a cost of 0,50€/ drill (net value).

Out-of-size doors billed for the next larger dimension.

 Non- standard doors, different from the tabled measurements, calculate price per m2, **290€**

\*Add 10% to the price table

**Aluminium Handle**

Doors up to 447mm wide = 8,50€

Doors with a width between 487 and 797mm = 10,75€

Doors with a width between 897 and 1197mm = 15,15€

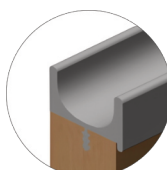
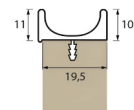
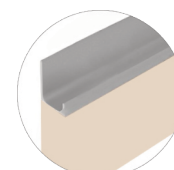
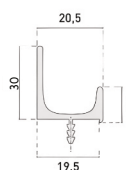

"J" Handle

"U" Handle

**IMPORTANT NOTES**

VAT not included.

Price should be understood as "Ex Works" (EXW).

This table can be changed without prior notice, nullifying all its previous editions.